

# FLUORESCENT LIGHTING

Project Name:	
Type: <b>NL-27</b>	Notes:
Catalog #:	

## PUF - Puff Series



2-Lite



4-Lite



### Applications

For low to medium ceiling applications including office buildings, supermarkets, exhibition center, conference rooms, where additional light is needed.

### Specification Features

- Heavy gauge die-formed steel construction.
- One piece acrylic diffuser with prism for convenient snap in maintenance.
- Standard white powdercoat finish for maximum rust and corrosion proof.
- Contractor-friendly pushwire wall-nuts standard for convenient installation. Twist-lock lampholders standard on all linear lamp models.
- Available in 2 or 4 lamps.
- Energy efficient, thermally protected, Class P, HPF, sound rated A, UL listed, electronic ballast.
- Provided with pushwire wall-nuts or luminaire disconnects for convenient installation.
- U.L. listed for damp locations.

### Dimensions

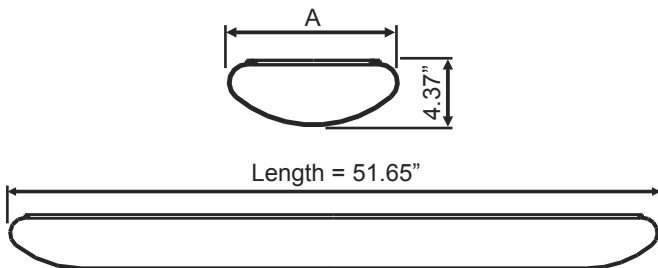

Model #	Width (A)	Watts
PUF (2-Lite)	11.26"	2 x 32wT8
PUF (4-Lite)	16.7"	4 x 32wT8

### Ordering Information

Example: PUF 232 UNV EB LPI

Series	# of Lamps	Wattage	Diffuser Type	Voltage	Options
PUF - Puff Series	2 - 2 lamps	17 - 17wT8 (24")	(blank) - Prismatic acrylic diffuser	120 - 120V	<b>EB</b> - Electronic ballast, <10% THD <b>EB2</b> - Two electronic ballasts <b>EM</b> - Emergency battery pack <b>DS</b> - Luminaire disconnect <b>LPI</b> - Lamp included (Specify lamp type and color) (Consult factory for additional options.)
	4 - 4 lamps	32 - 32wT8 (48") (Consult factory for others.)		277 - 277V UNV - 120/277V (Consult factory for others.)	

Manufacturer reserves the right to make changes to specifications without notice.